

**Product number C12480\_MIRELLA-50-S-PIN**

Family	Mirella	FWHM	8,7 degrees
Type	Reflector	Efficiency	90 %
LED	XM-L	cd/Im	19.340
Color	Metal	Gerber File	Available
Diameter	49.9 mm	Please note that the position pin holes come very close to the LED.	
Height	23.9 mm		
Style	Round		
Optic Material	PC		
Holder Material	-		
Fastening	["pin"]		
Status	Production ready		

**Product number CN12486\_MIRELLA-50-S-PIN-DL**

Family	Mirella	FWHM	12 degrees
Type	RefPack	Efficiency	86 %
LED	XM-L	cd/Im	8.730
Color	Metal	Gerber File	Available
Diameter	49.9 mm	Please note that the position pin holes come very close to the LED.	
Height	23.9 mm		
Style	Round		
Optic Material	PC		
Holder Material	-		
Fastening	["pin"]		
Status	Production ready		

**Product number CN13354\_MIRELLA-50-S-PIN-CL**

Family	Mirella	FWHM	12 degrees
Type	RefPack	Efficiency	85 %
LED	XM-L	cd/Im	11.380
Color	Metal	Gerber File	Available
Diameter	49.9 mm	Please note that the position pin holes come very close to the LED.	
Height	23.9 mm		
Style	Round		
Optic Material	PC		
Holder Material	-		
Fastening	""		
Status	Production ready		

**Product number C12481\_MIRELLA-50-M-PIN**

Family	Mirella	FWHM	24 degrees
Type	Reflector	Efficiency	89 %
LED	XM-L	cd/Im	2.900
Color	Metal	Gerber File	Available
Diameter	49.9 mm	Please note that the position pin holes come very close to the LED.	
Height	23.9 mm		
Style	Round		
Optic Material	PC		
Holder Material	-		
Fastening	["pin"]		
Status	Production ready		

**Product number C12482\_MIRELLA-50-W-PIN**

Family	Mirella	FWHM	32 degrees
Type	Reflector	Efficiency	88 %
LED	XM-L	cd/Im	1.630
Color	Metal	Gerber File	Available
Diameter	49.9 mm	Please note that the position pin holes come very close to the LED.	
Height	23.9 mm		
Style	Round		
Optic Material	PC		
Holder Material	-		
Fastening	["pin"]		
Status	Production ready		

**Product number CN12487\_MIRELLA-50-M-PIN-DL**

Family	Mirella	FWHM	35 degrees
Type	RefPack	Efficiency	80 %
LED	XM-L	cd/Im	1.500
Color	Metal	Gerber File	Available
Diameter	49.9 mm	Please note that the position pin holes come very close to the LED.	
Height	23.9 mm		
Style	Round		
Optic Material	PC		
Holder Material	-		
Fastening	["pin"]		
Status	Production ready		

**Product number CN13522\_MIRELLA-50-W-PIN-CL**

Family	Mirella	FWHM	45 degrees
Type	RefPack	Efficiency	86 %
LED	XM-L	cd/Im	1.400
Color	Metal	Gerber File	Available
Diameter	49.9 mm	Please note that the position pin holes come very close to the LED.	
Height	23.9 mm		
Style	Round		
Optic Material	PC		
Holder Material	-		
Fastening	["pin"]		
Status	Production ready		

**Product number CN12488\_MIRELLA-50-W-PIN-DL**

Family	Mirella	FWHM	46 degrees
Type	RefPack	Efficiency	80 %
LED	XM-L	cd/Im	1.000
Color	Metal	Gerber File	Available
Diameter	49.9 mm	Please note that the position pin holes come very close to the LED.	
Height	23.9 mm		
Style	Round		
Optic Material	PC		
Holder Material	-		
Fastening	["pin"]		
Status	Production ready		



## PRODUCT DATASHEET

### Mirella series

last update 24/6/2013

**NOTE:** The typical divergence will be changed by different color, chip size and chip position tolerance. The typical total divergence is the full angle measured where the luminous intensity is half of the peak value.

**Relative intensity of C12480\_MIRELLA-50-S-PIN\_(XM-L)**

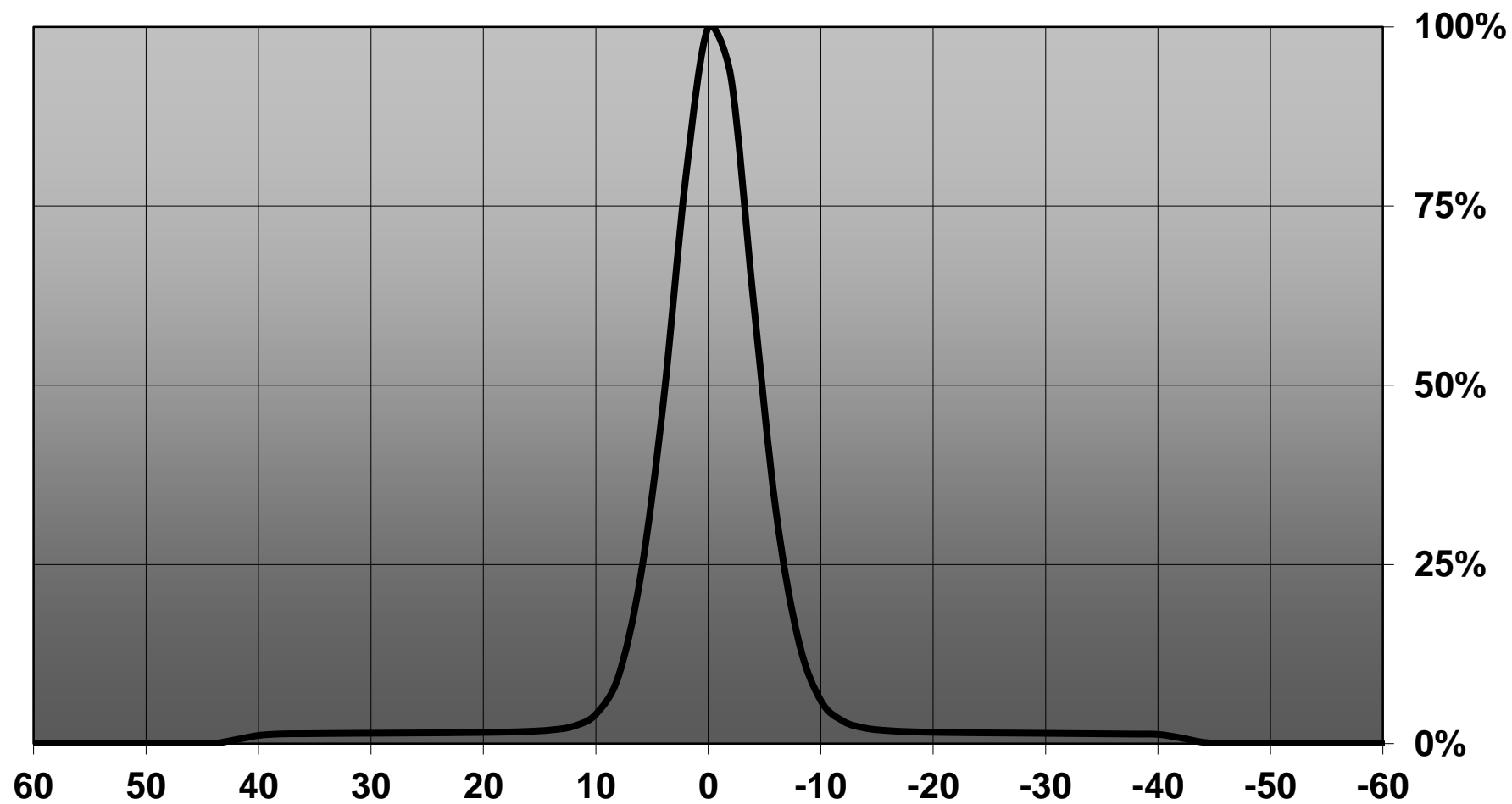

Relative intensity of CN12486\_MIRELLA-50-S-PIN-DL\_(XM-L)

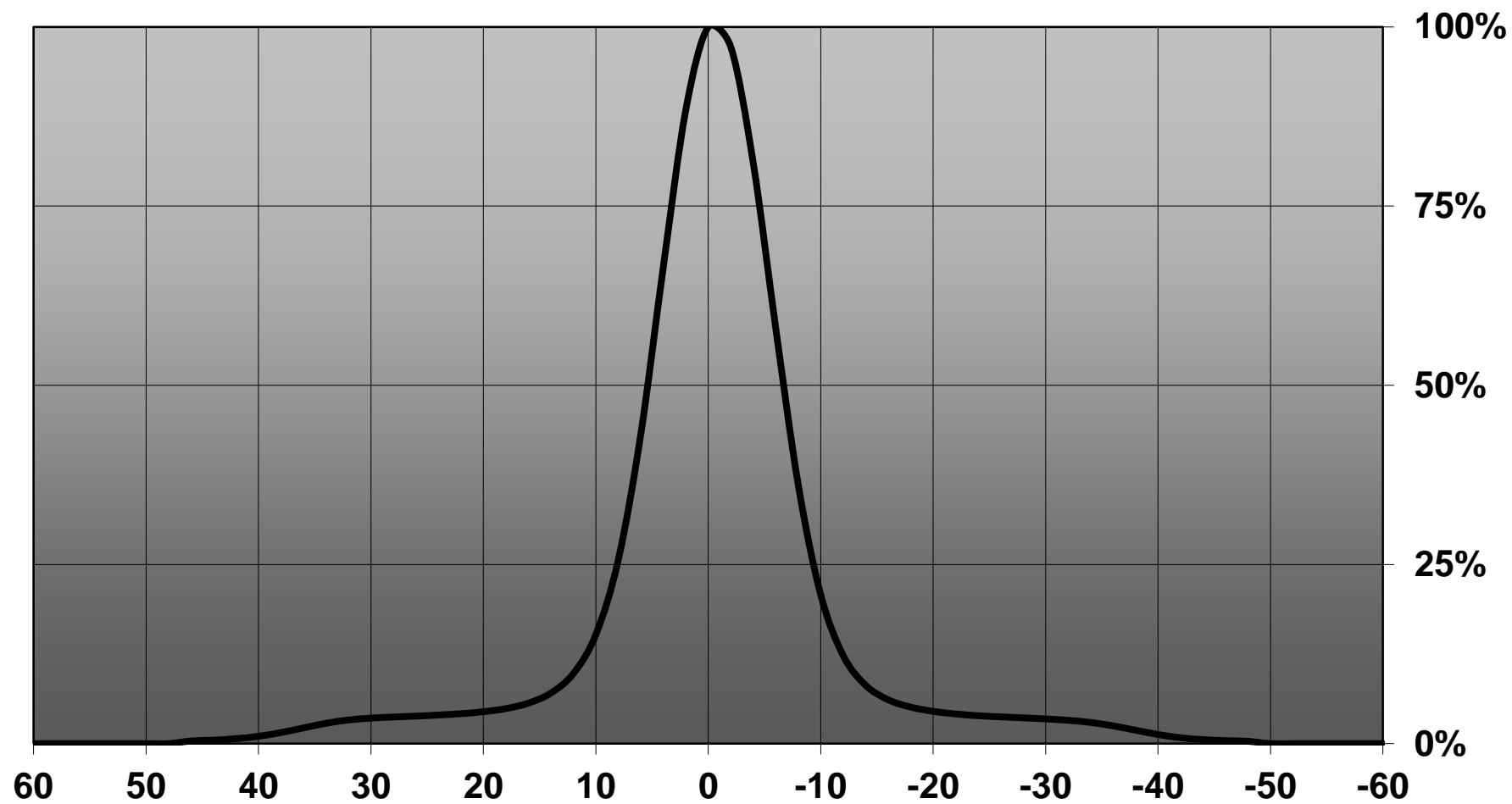

Relative intensity of CN13354\_MIRELLA-50-S-PIN-CL\_(XM-L)

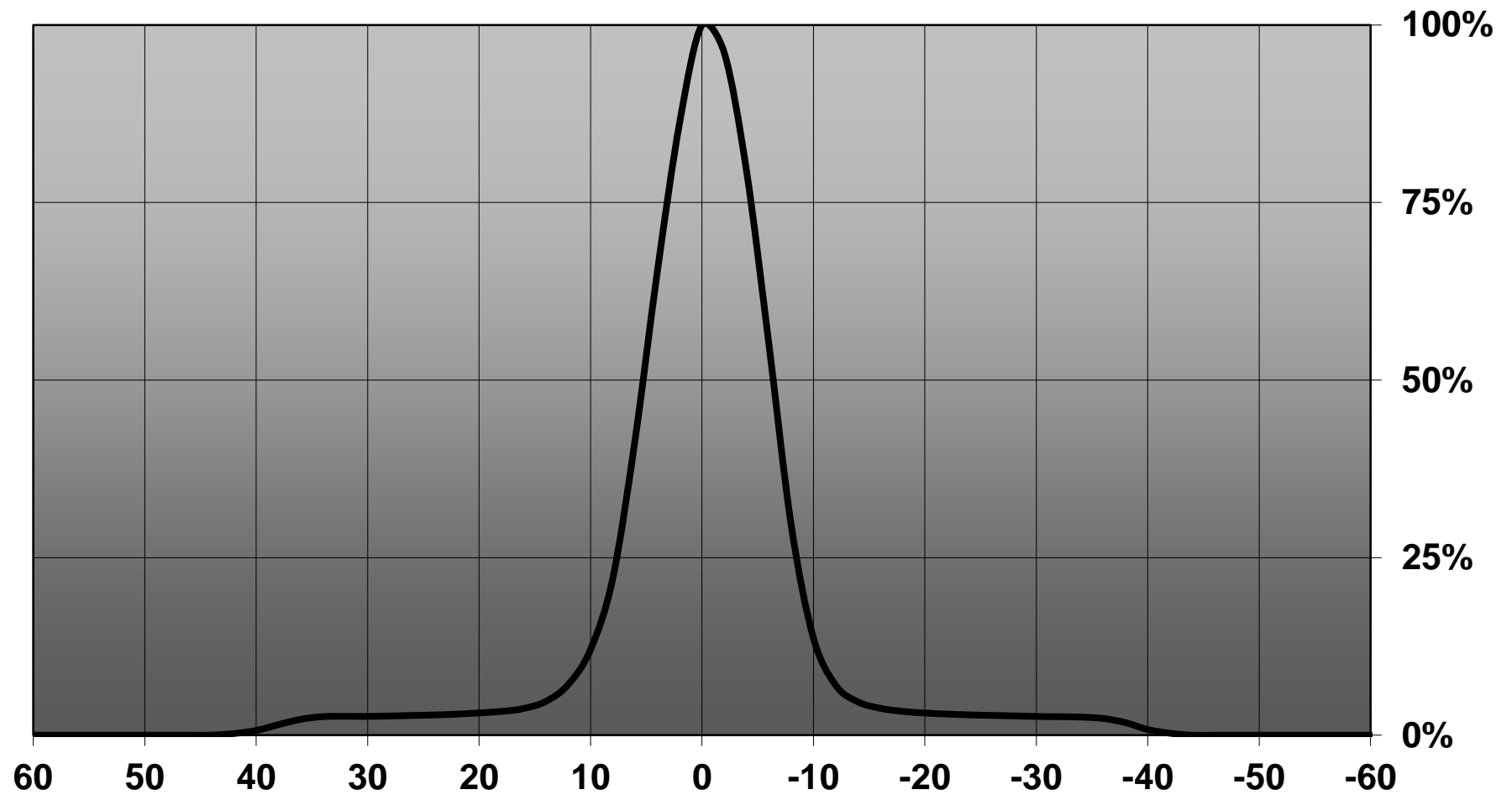

Relative intensity of C12481\_Mirella\_50-M-PIN\_(XM-L)

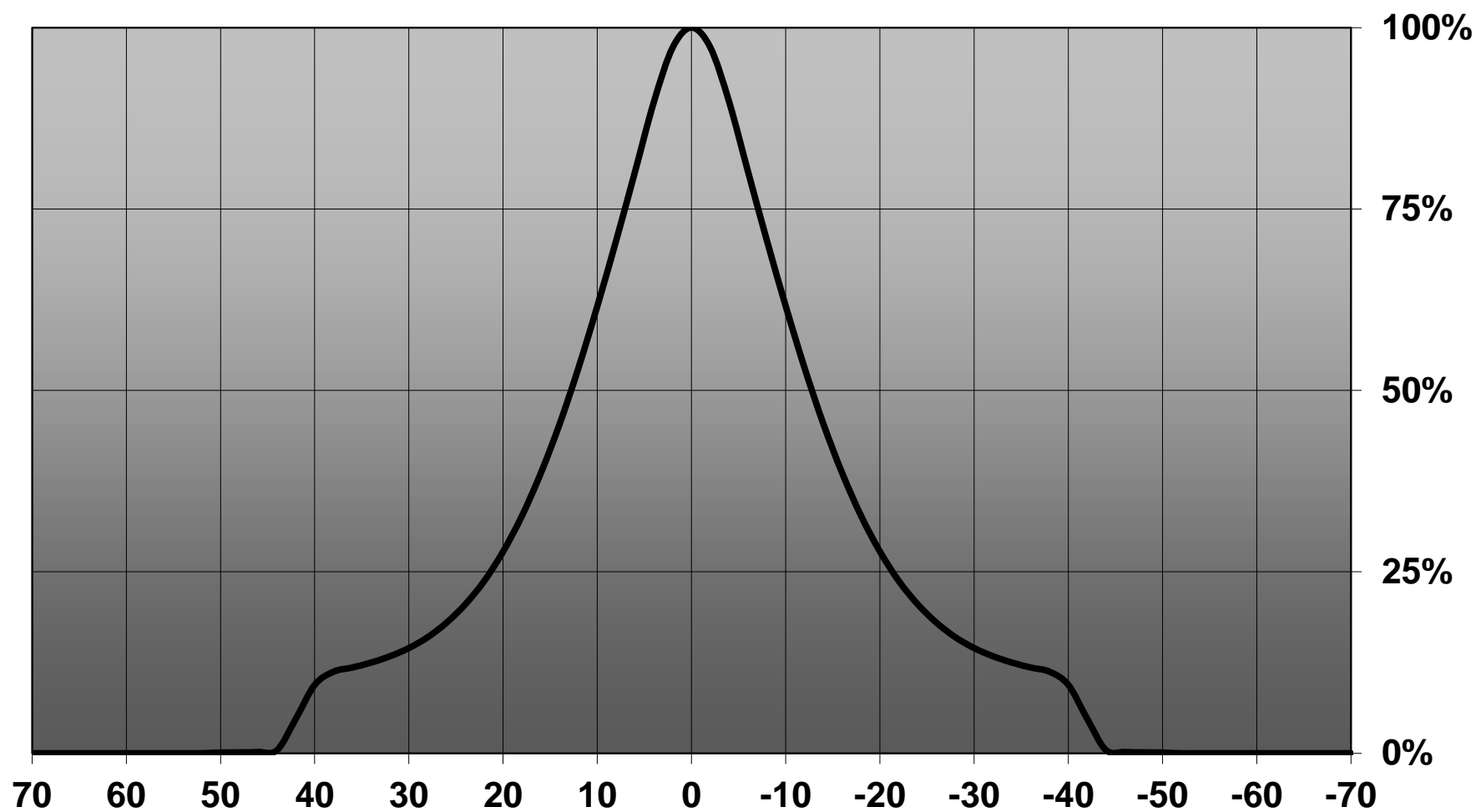

Relative intensity of C12482\_Mirella\_50-W-PIN\_(XM-L)

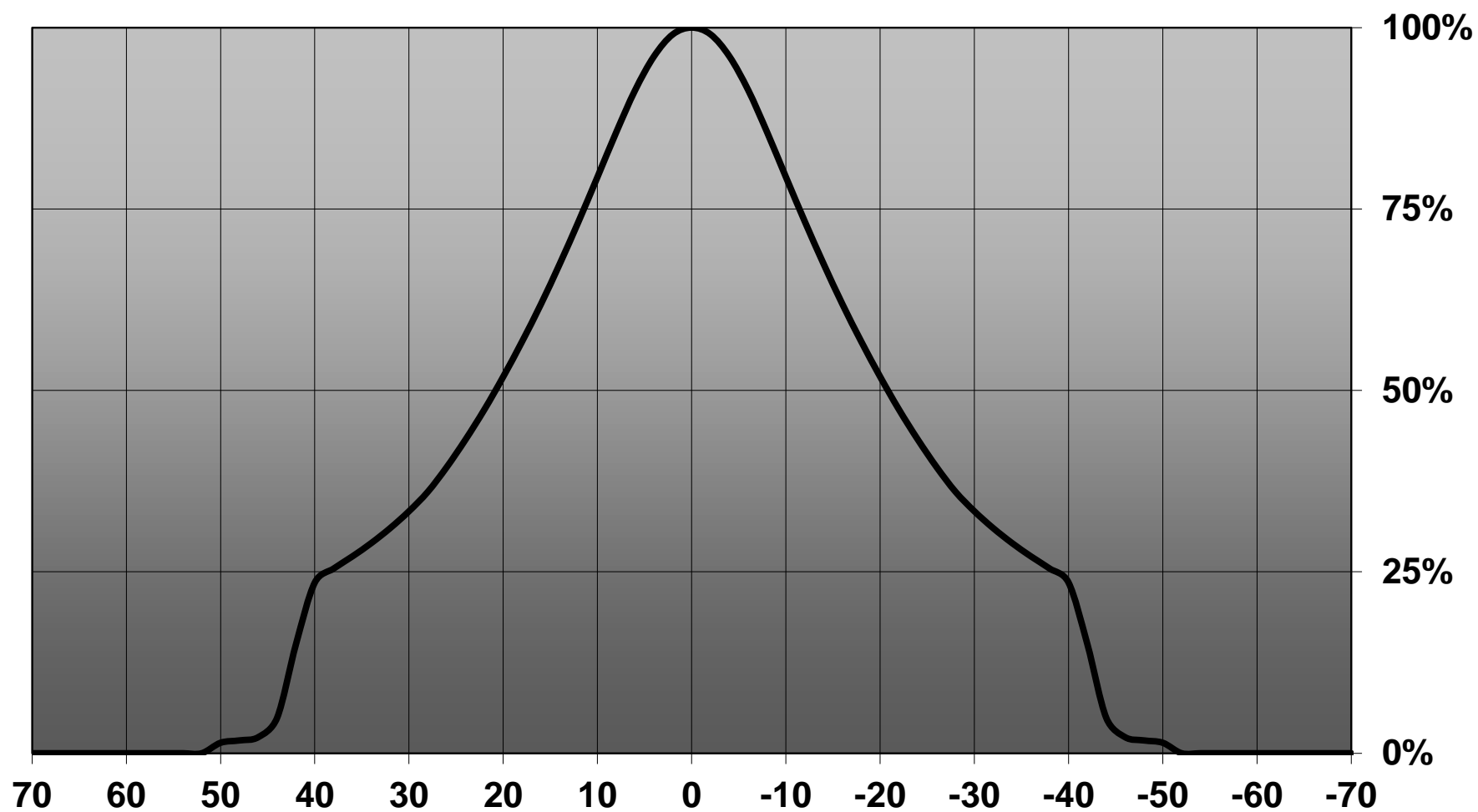



Relative intensity of CN12487\_MIRELLA-50-M-PIN-DL\_(XM-L)

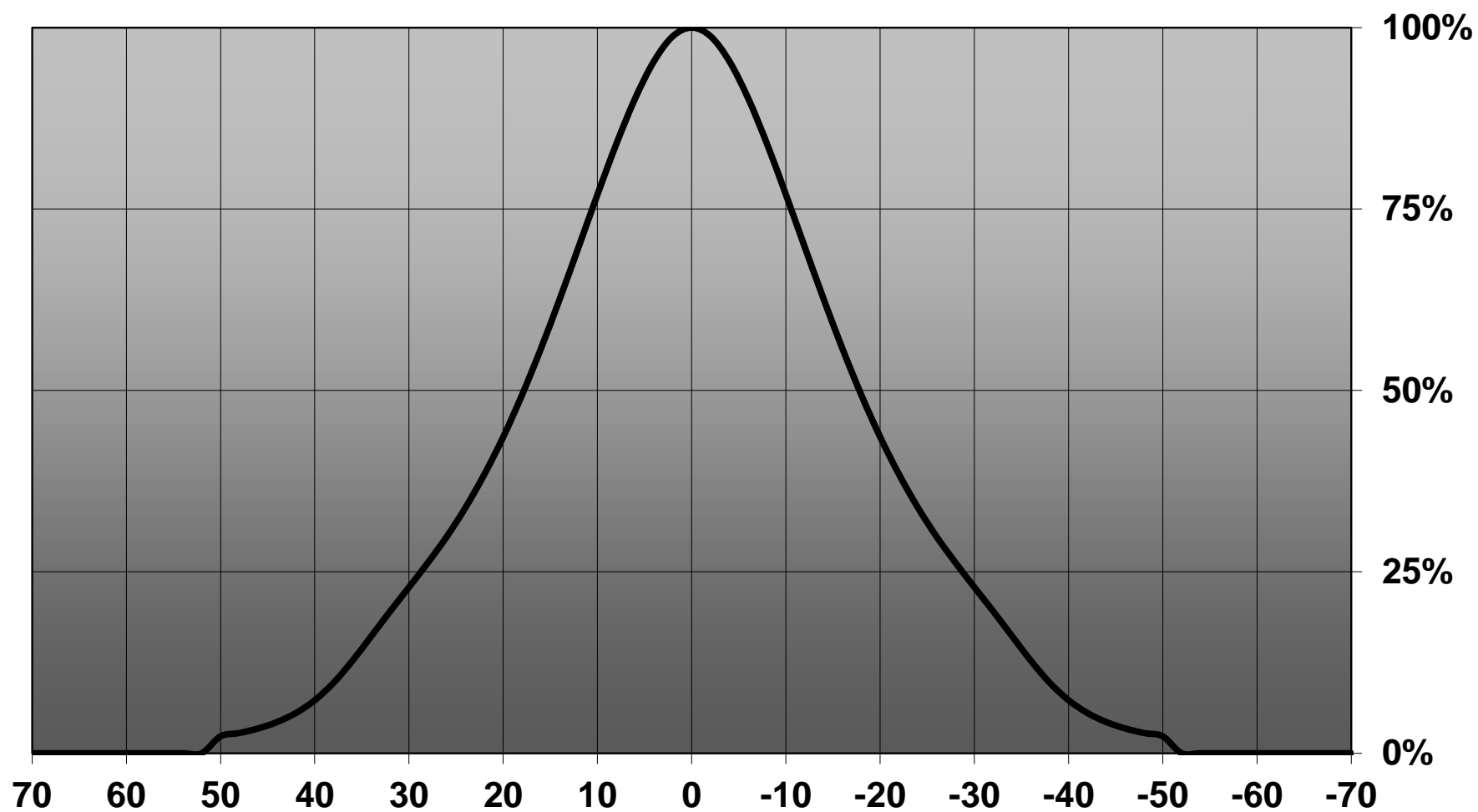

Relative intensity of CN12488\_MIRELLA-50-W-PIN-DL\_(XM-L)

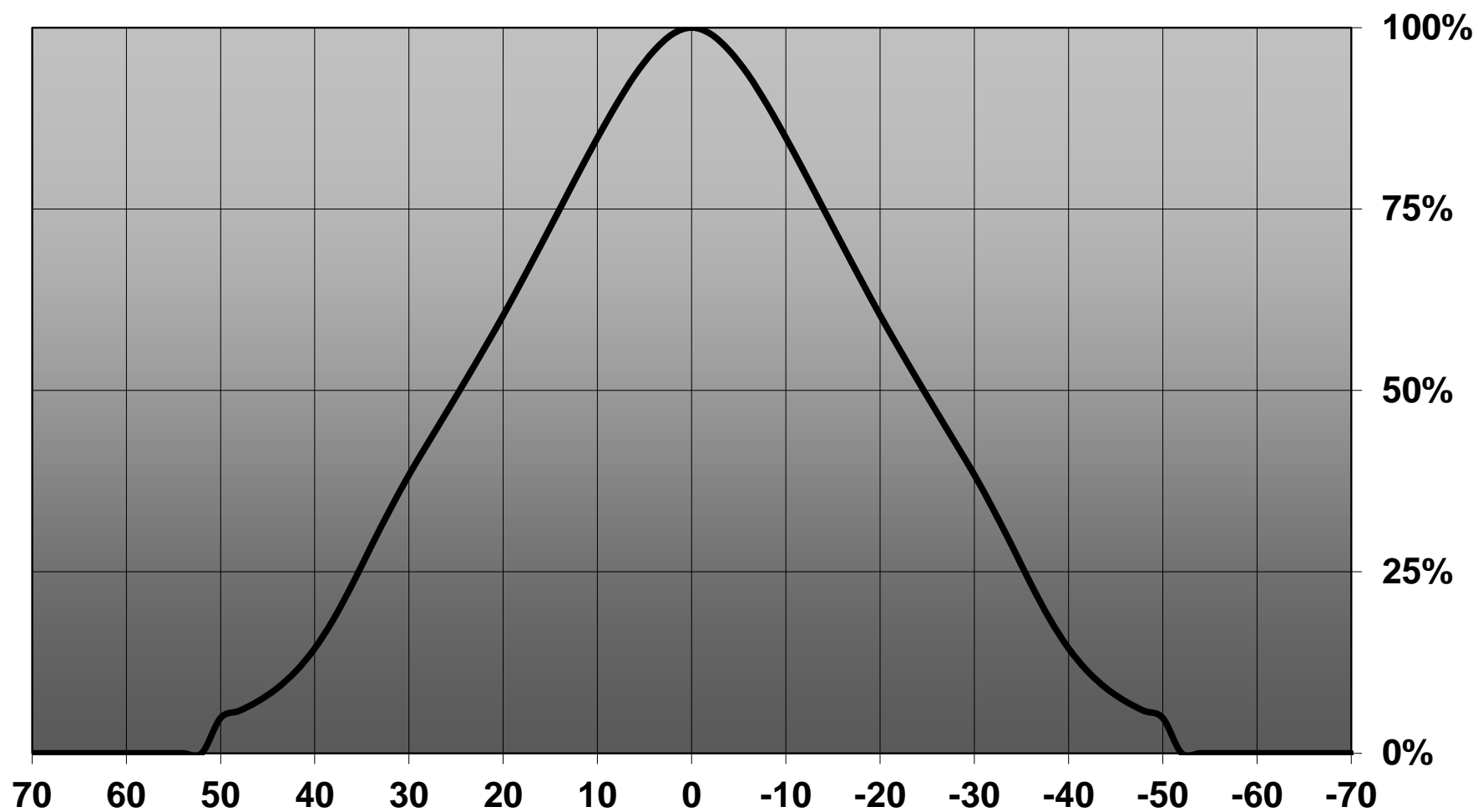

D

C

B

A

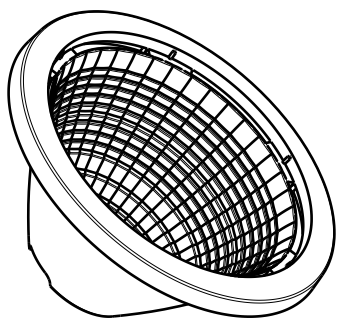

Isometrric view

8.6 C/C

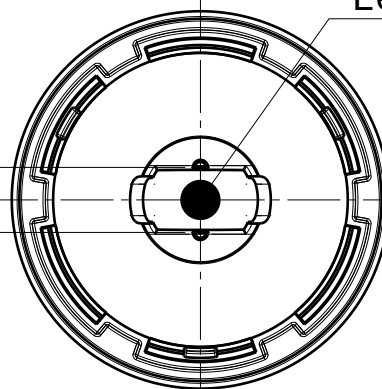

Led position

Botto view

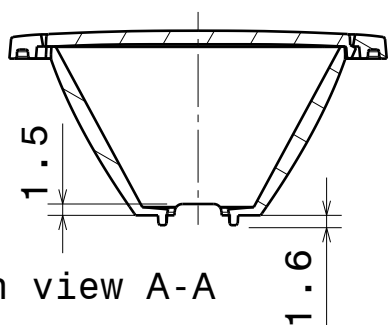

Section view A-A

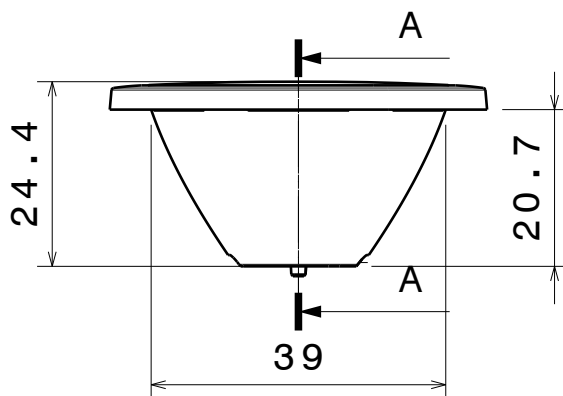

Front view

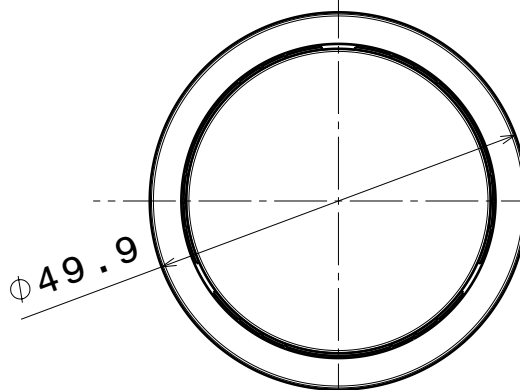

Top view

Tolerances if not otherwise shown  
According to DIN ISO 2768-1  
Linear measures:  
Up to 30mm class M, otherwise class C.  
According to DIN ISO 2768-2  
Form and position: class L

LEDiL

Ledil Oy  
Salorankatu 10  
FIN 24240 SALO  
Finland

THIRD ANGLE PROJECTION:

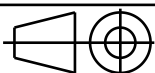

DRAWING TITLE

Datasheet\_Mirella\_pin

This drawing is the property  
of LEDiL Oy. It may not be  
reproduced, copied or  
communicated without a written  
agreement with LEDiL Oy."

SIZE

A4

PART NUMBER

-

SCALE

1:1

WEIGHT

-

SHEET

1/1

D

A

Luminaire: Ledil Oy C12480\_MIRELLA-50-S-PIN (Cree XM-L 92lm @ 250mA) Efficiency=89%  
Lamps: 1 x Cree XM-L 92lm @ 250mA

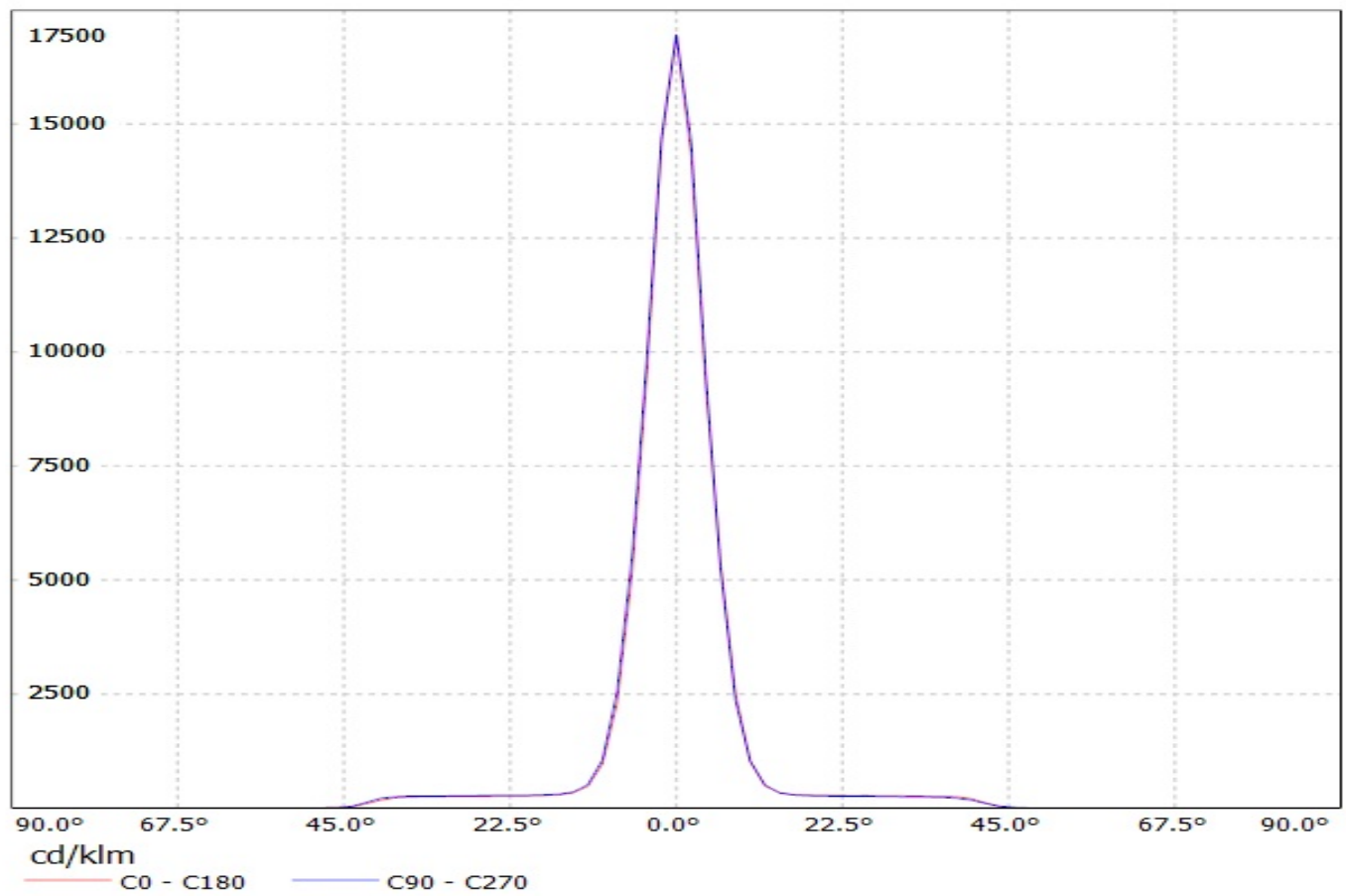

Luminaire: Ledil Oy C12481\_Mirella\_50-M-PIN (Cree XM-L 111lm @ 250mA) Efficiency=89%  
Lamps: 1 x Cree XM-L 111lm @ 250mA

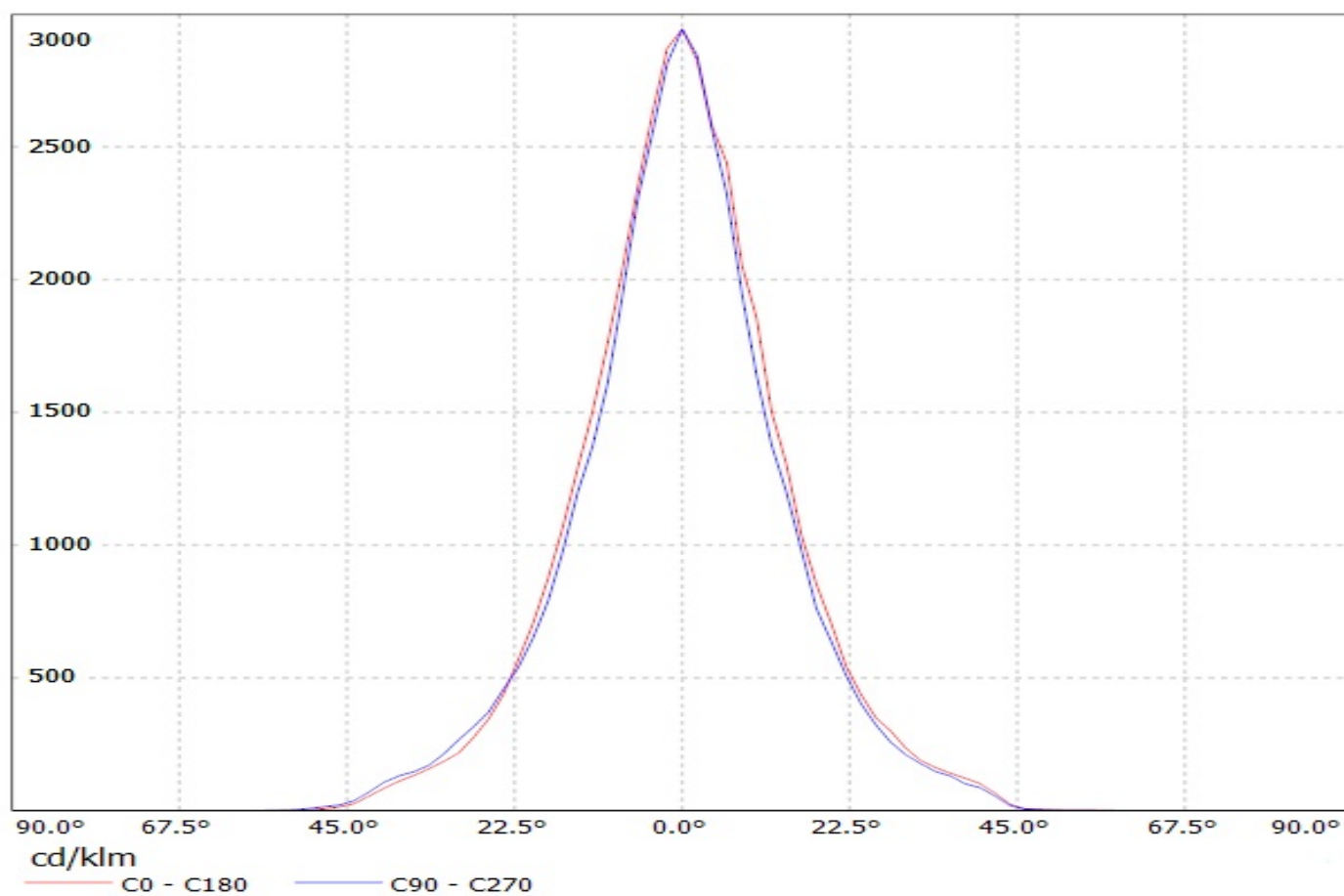

Luminaire: Ledil Oy C12482\_Mirella\_50-W-PIN (Cree XM-L 111lm @ 250mA) Efficiency=88%  
Lamps: 1 x Cree XM-L 111lm @ 250mA

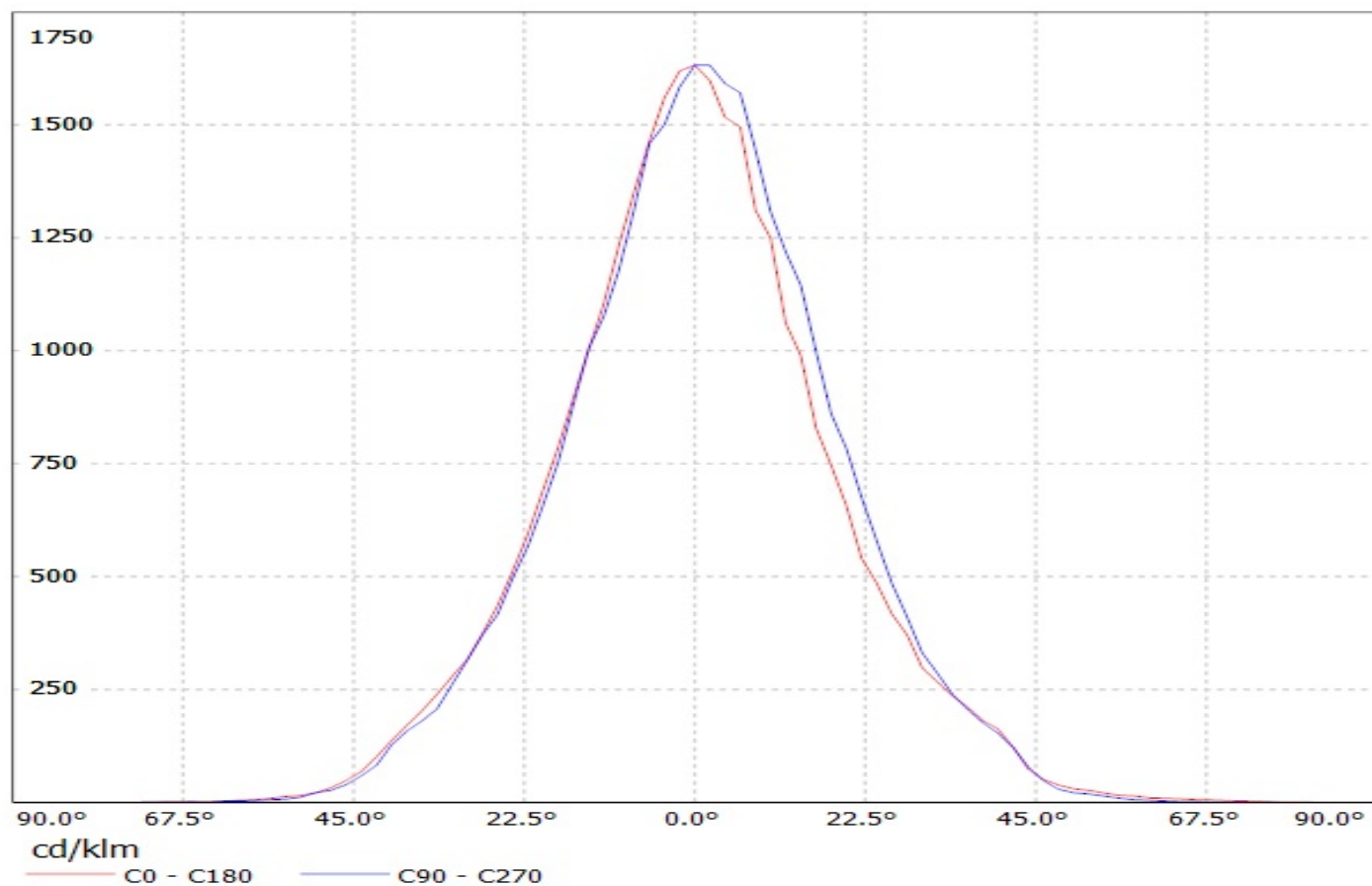

Luminaire: Ledil Oy CN12487\_MIRELLA-50-M-PIN-DL (Cree XM-L 111lm @ 250mA) Efficiency=80%  
Lamps: 1 x Cree XM-L 111lm @ 250mA

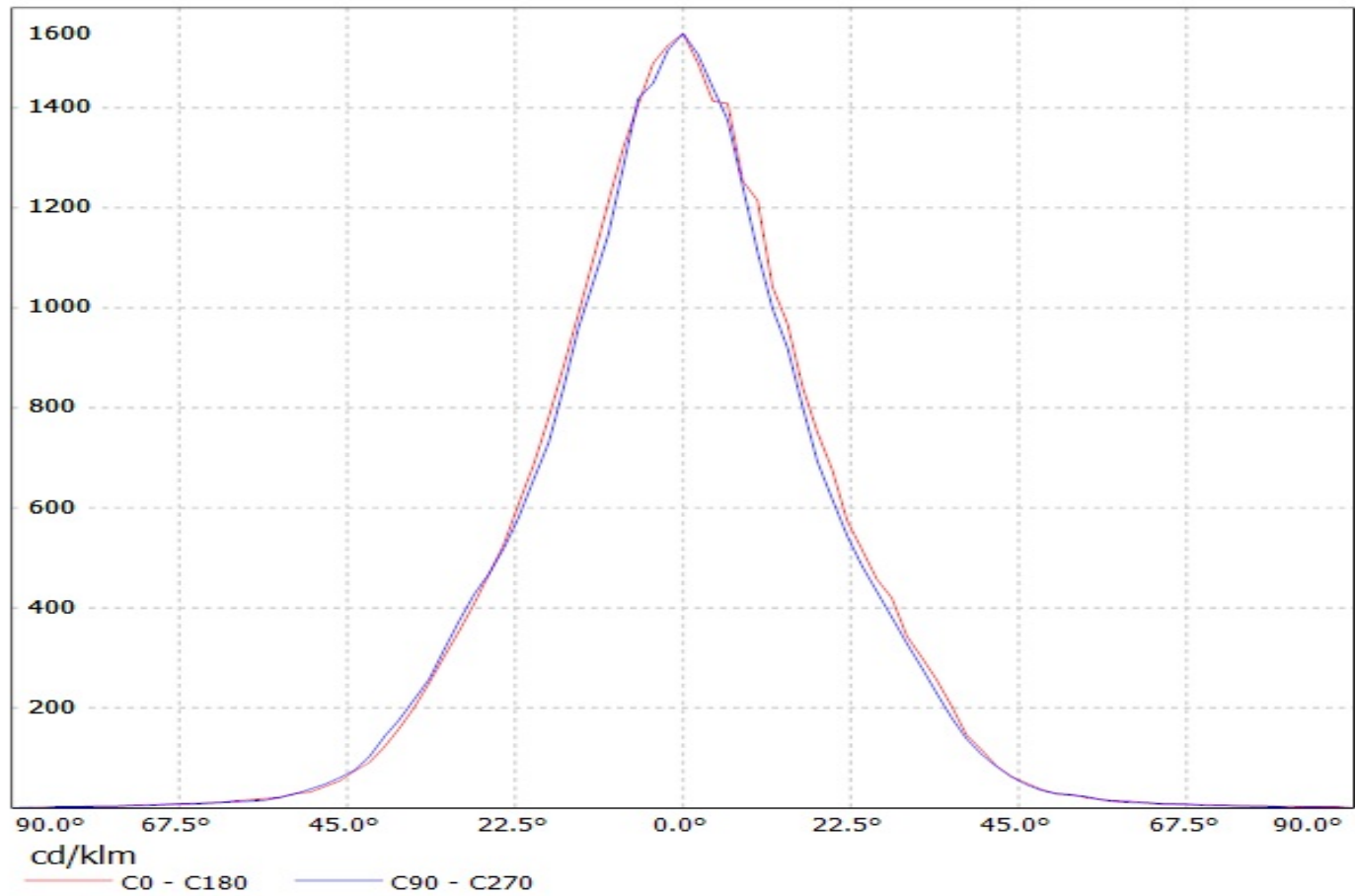

Luminaire: Ledil Oy CN13522\_MIRELLA-50-W-PIN-CL (Cree XM-L 92lm @ 250mA) Efficiency=86%  
Lamps: 1 x Cree XM-L 92lm @ 250mA CCT=3284K P=0,76W I=250mA

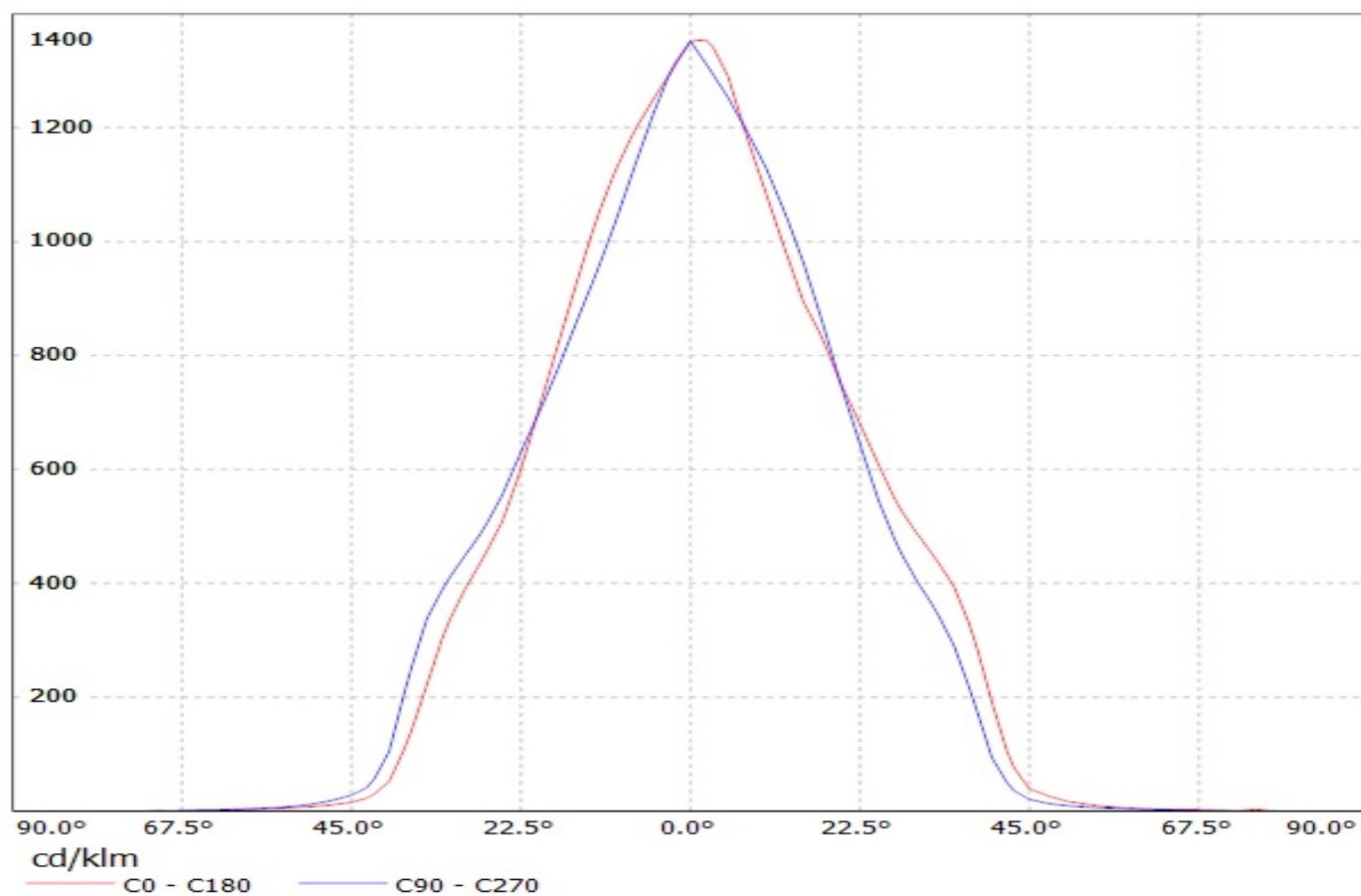



Luminaire: Ledil Oy CN12488\_MIRELLA-50-W-PIN-DL (Cree XM-L 111lm @ 250mA) Efficiency=80%  
Lamps: 1 x Cree XM-L 111lm @ 250mA

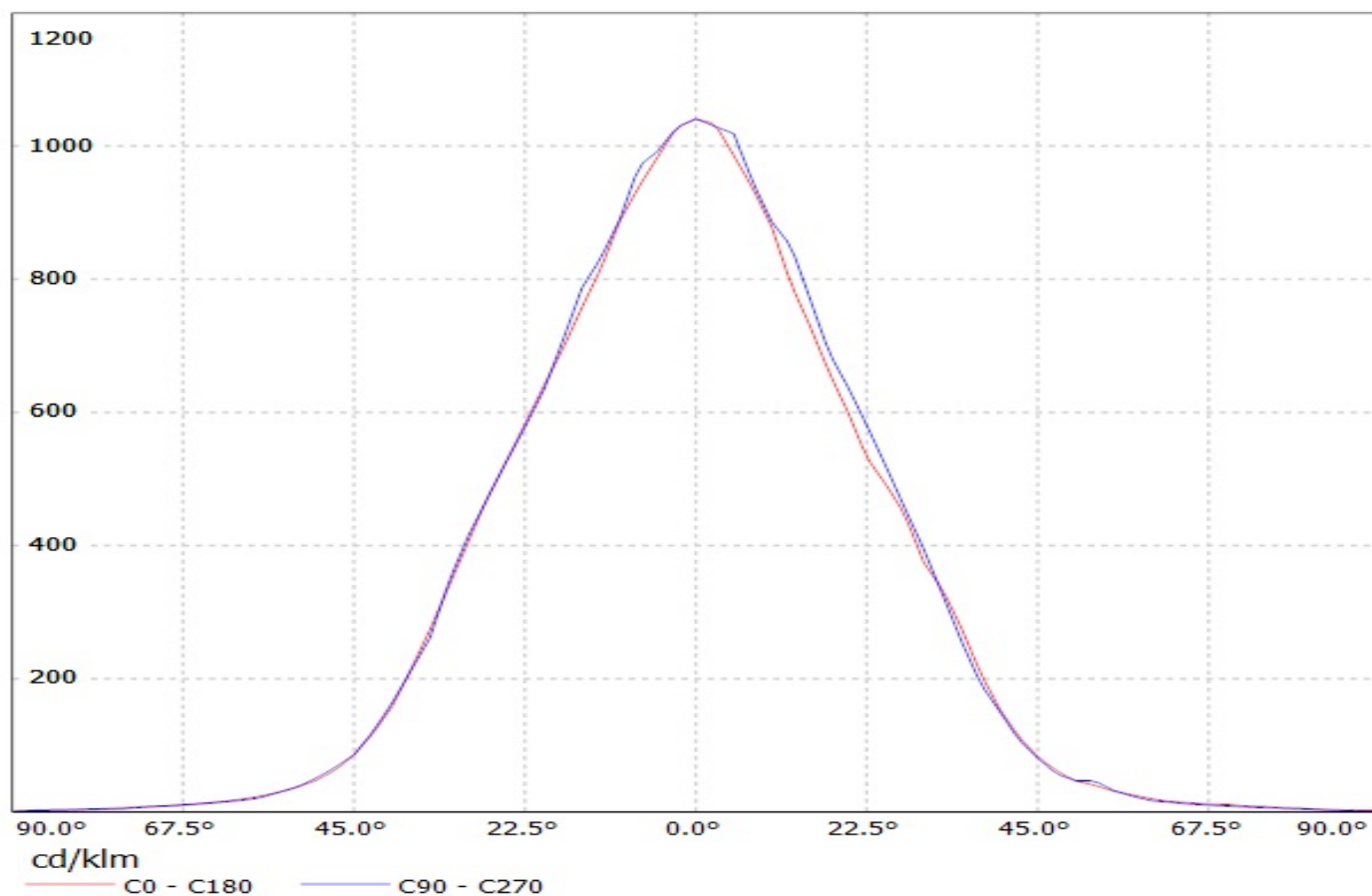

Luminaire: Ledil Oy C12480\_MIRELLA-50-S-PIN (Cree XM-L 92lm @ 250mA) Efficiency=89%  
Lamps: 1 x Cree XM-L 92lm @ 250mA

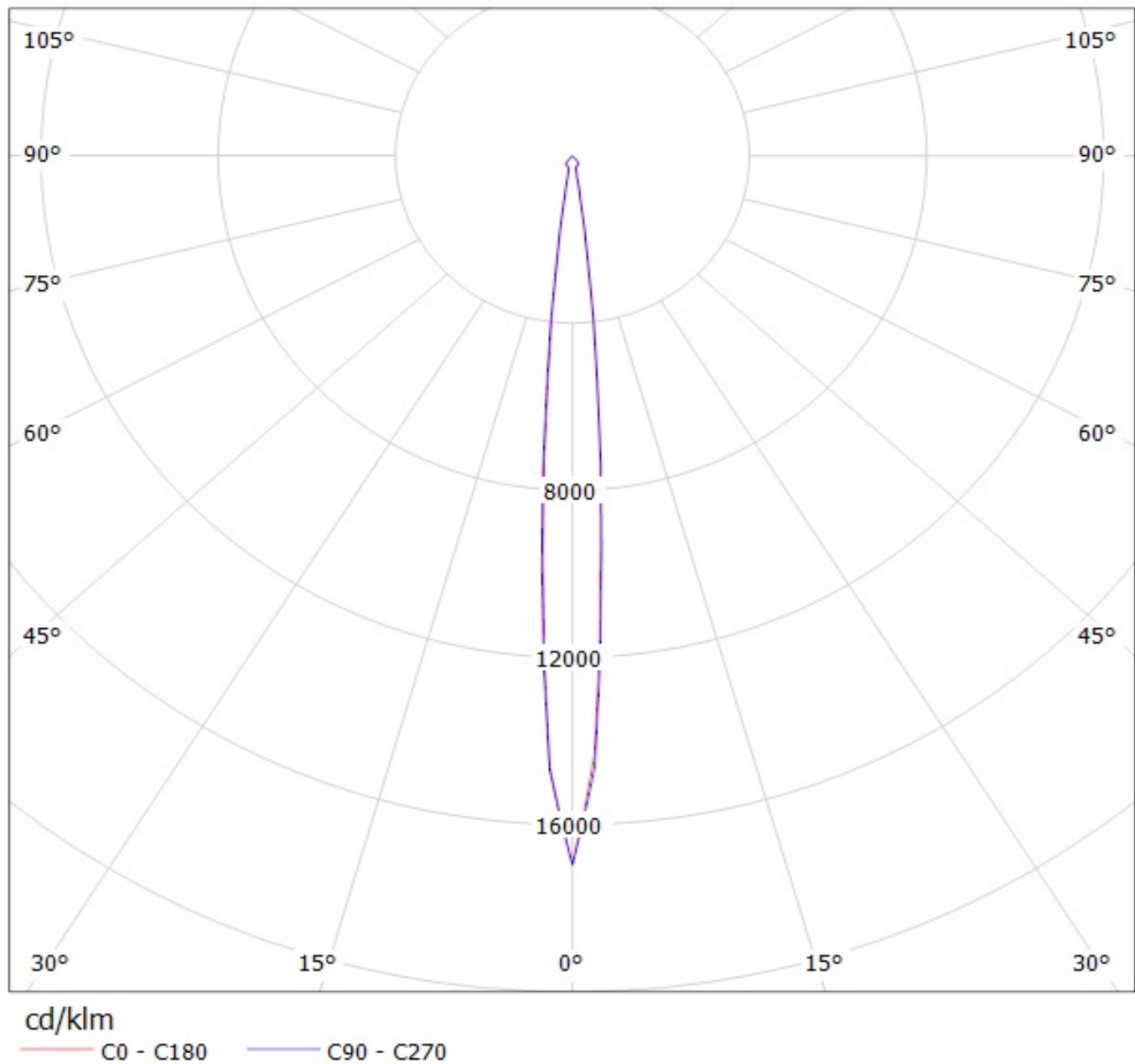

Luminaire: Ledil Oy C12481\_Mirella\_50-M-PIN (Cree XM-L 111lm @ 250mA) Efficiency=89%  
Lamps: 1 x Cree XM-L 111lm @ 250mA

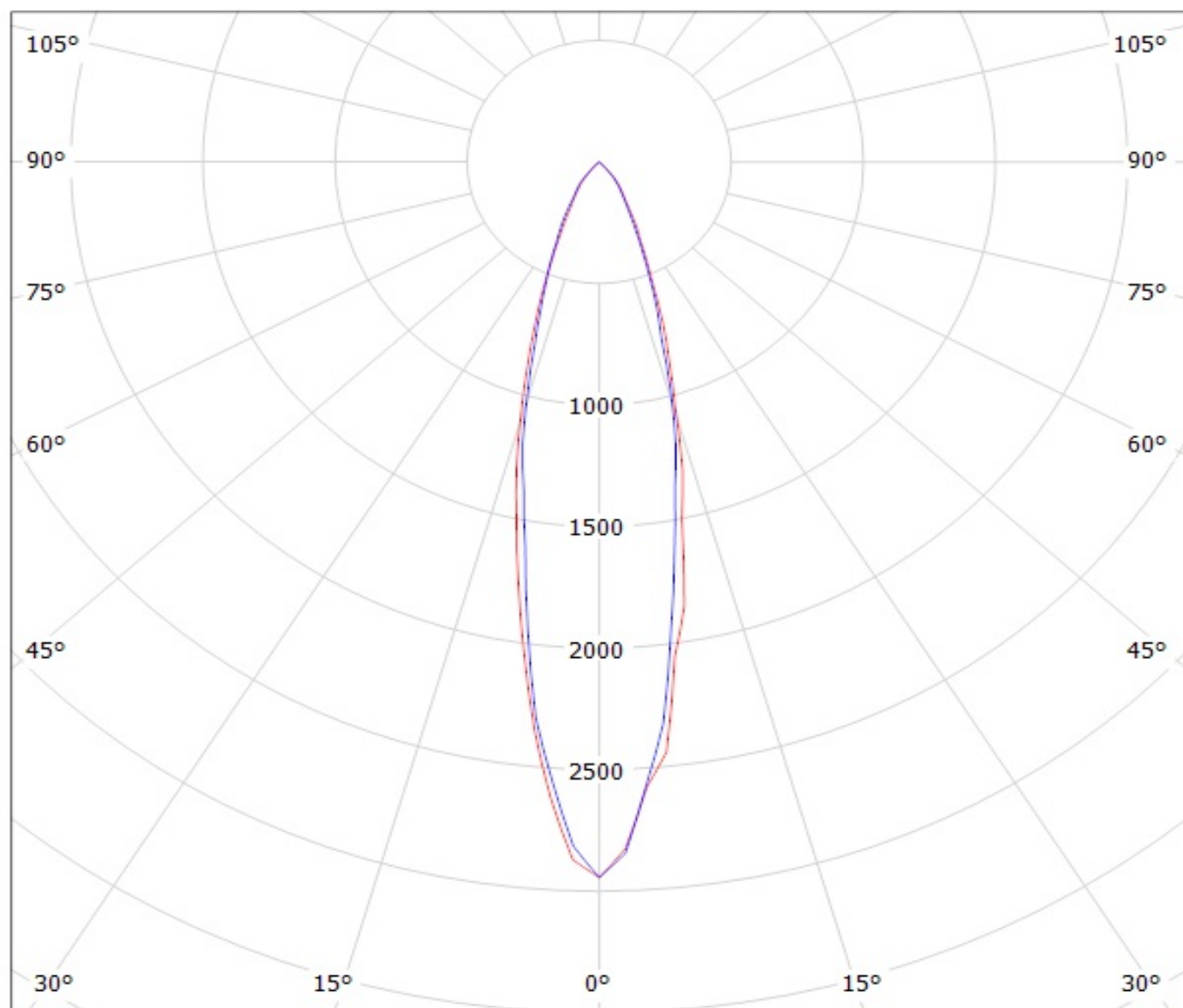

cd/klm

— C0 - C180

— C90 - C270

Luminaire: Ledil Oy C12482\_Mirella\_50-W-PIN (Cree XM-L 111lm @ 250mA) Efficiency=88%  
Lamps: 1 x Cree XM-L 111lm @ 250mA

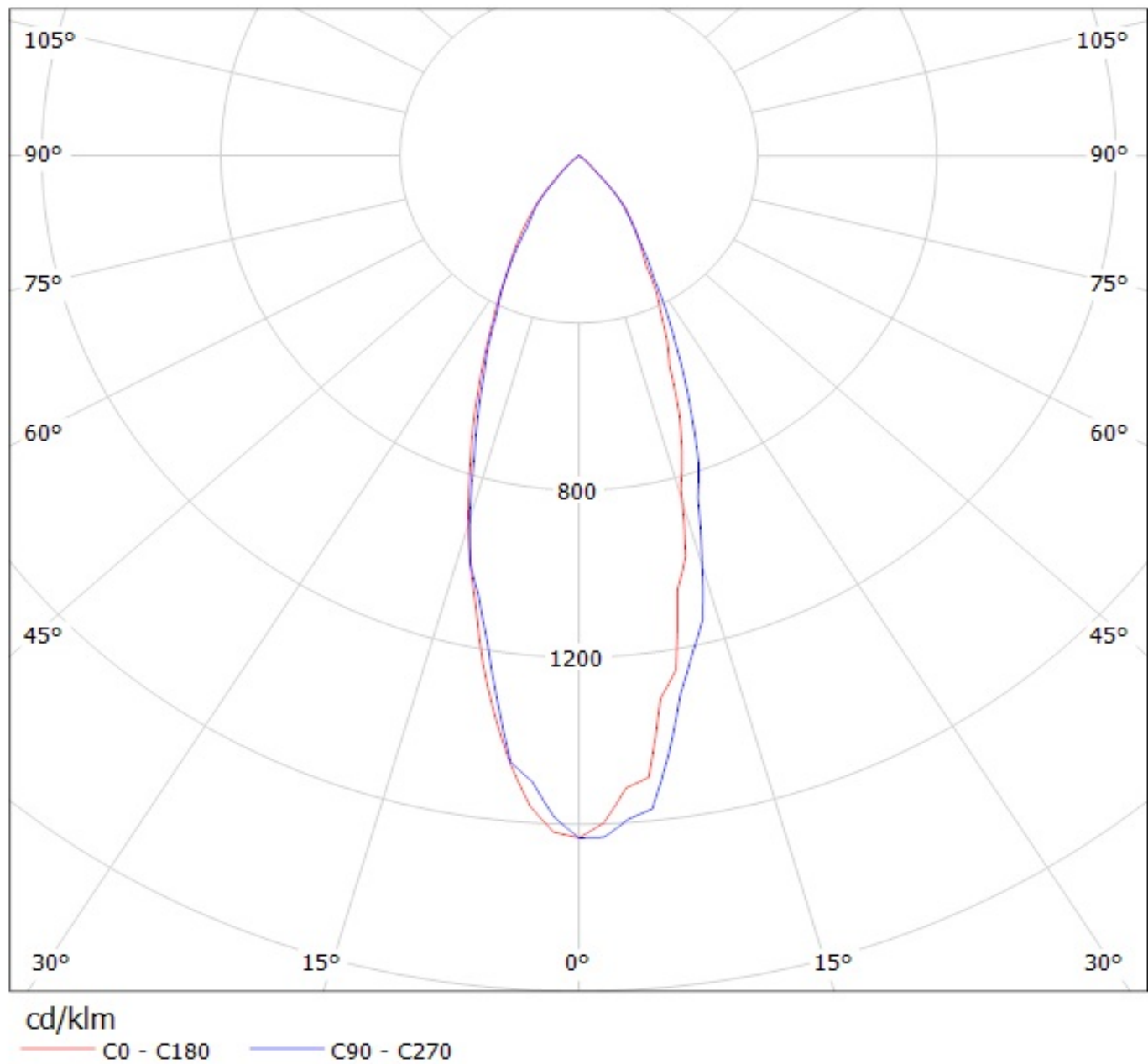

Luminaire: Ledil Oy CN12487\_MIRELLA-50-M-PIN-DL (Cree XM-L 111lm @ 250mA) Efficiency=80%  
Lamps: 1 x Cree XM-L 111lm @ 250mA

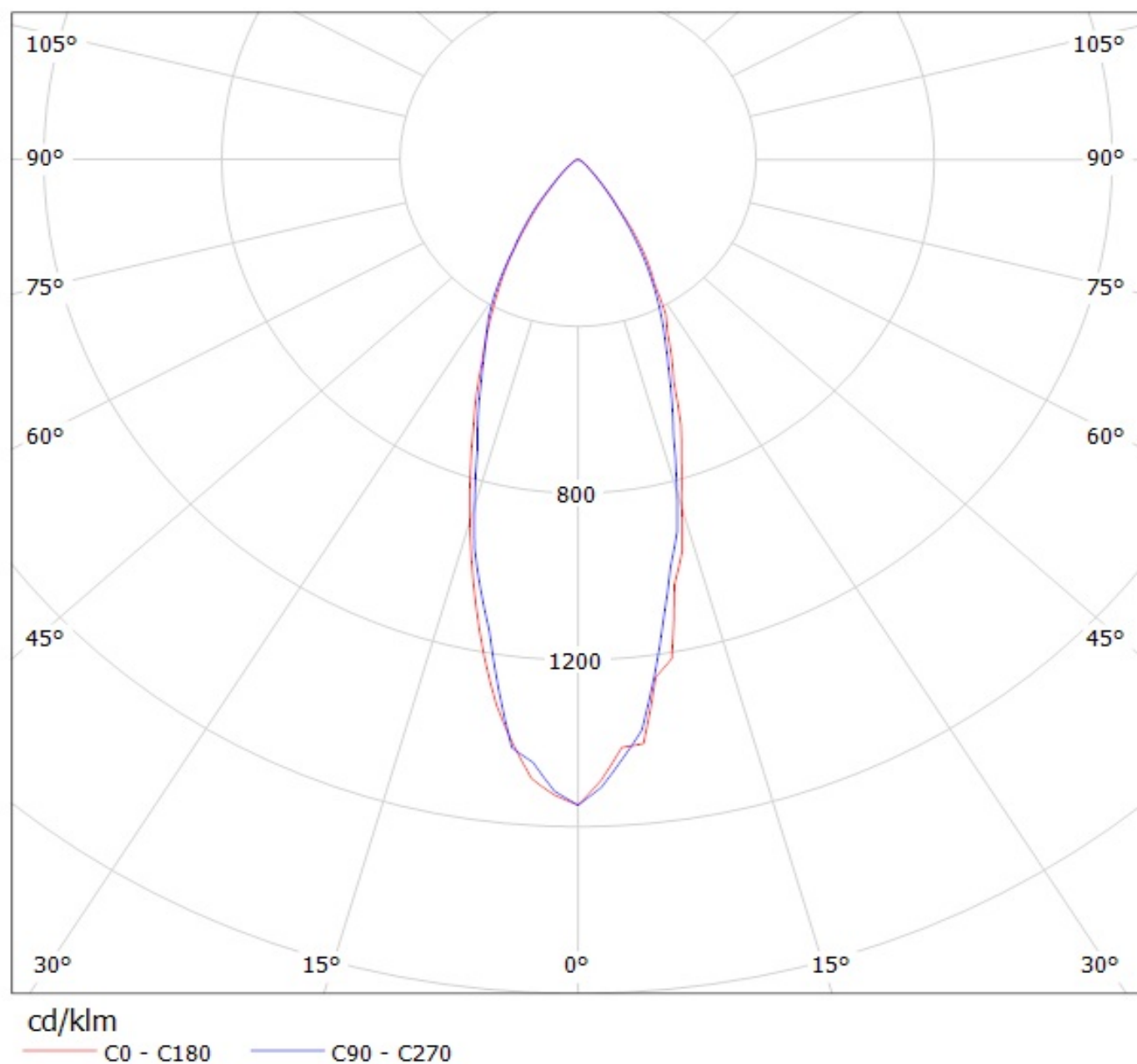

Luminaire: Ledil Oy CN13522\_MIRELLA-50-W-PIN-CL (Cree XM-L 92lm @ 250mA) Efficiency=86%  
Lamps: 1 x Cree XM-L 92lm @ 250mA CCT=3284K P=0,76W I=250mA

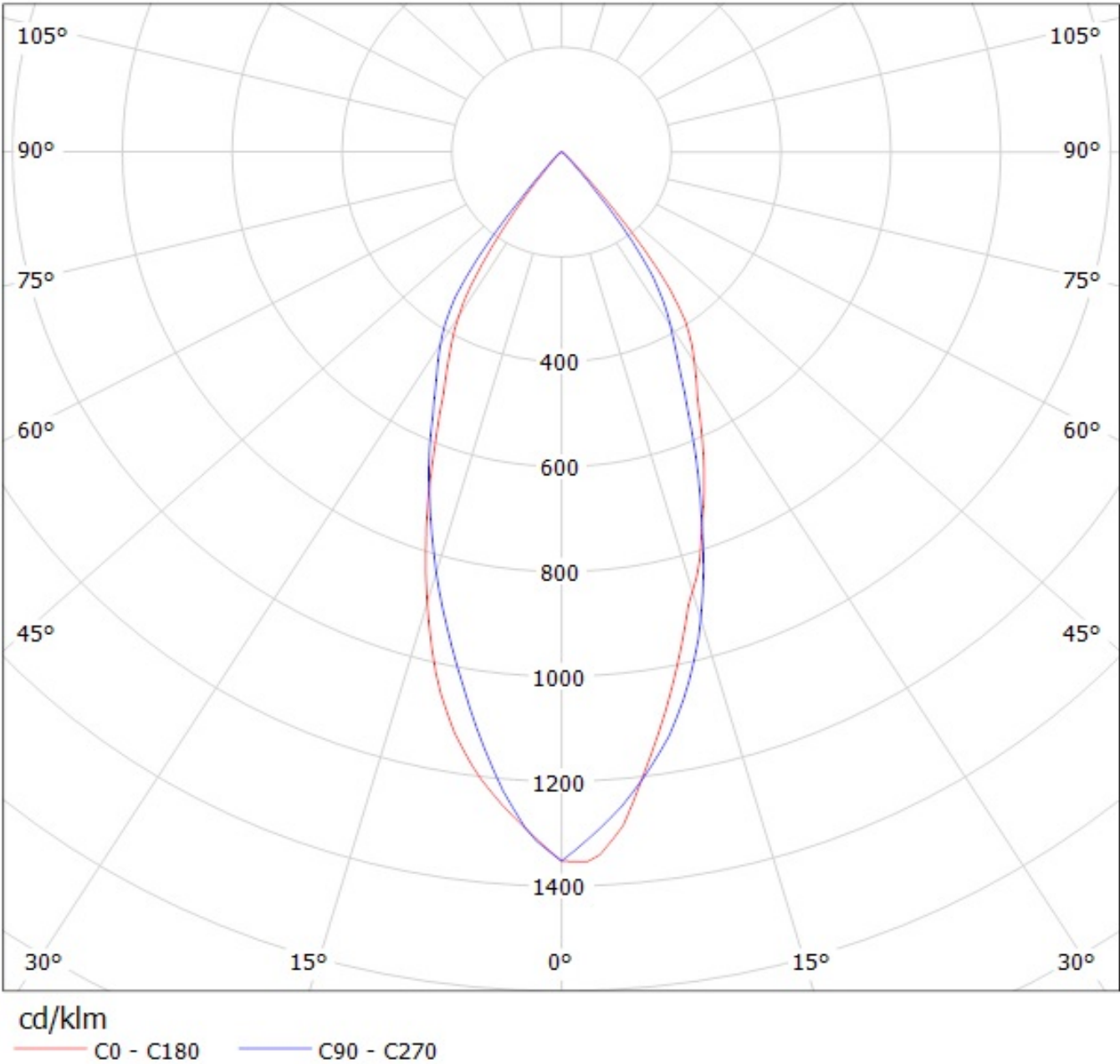

Luminaire: Ledil Oy CN12488\_MIRELLA-50-W-PIN-DL (Cree XM-L 111lm @ 250mA) Efficiency=80%  
Lamps: 1 x Cree XM-L 111lm @ 250mA

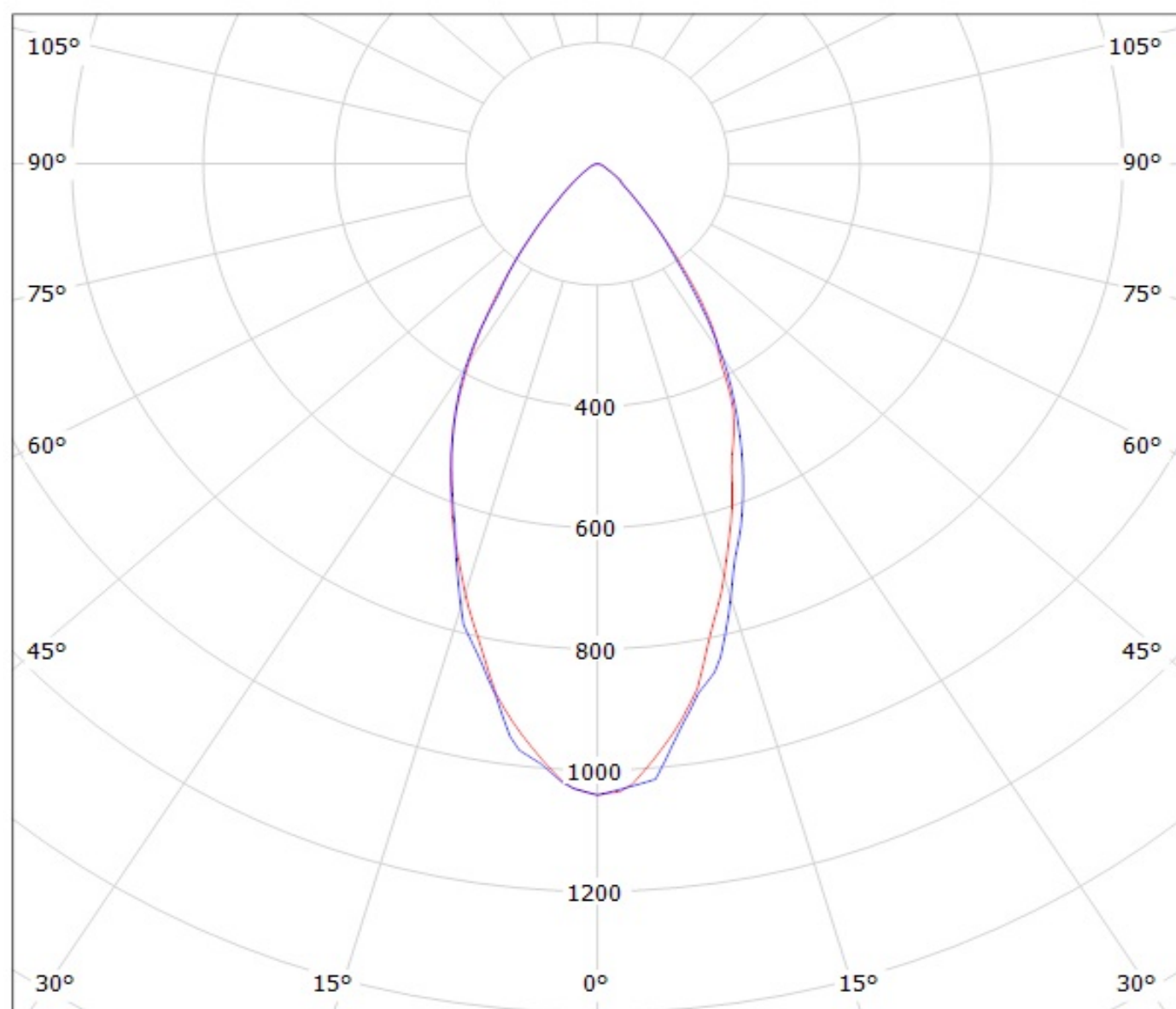

cd/klm

— C0 - C180

— C90 - C270